

A photograph of a stone gate leading into a wooded area. The gate is made of large, irregular, light-colored stones. The path is paved with dark gravel. The background is filled with lush green trees, including birches and pines. The sky is bright and overcast.

STONEGATE HILL FARM

Copake, New York

KLEMM REAL ESTATE INC
LITCHFIELD COUNTY'S PREMIER BROKERS

Stonegate Hill Farm, Copake, NY

Overlooking Copake Lake and the ridgeline escarpment of the Catskill Mountains as well as the wooded surround interspersed with farmland, this glorious and private estate parcel of 59± acres is entered through a stone-pillared entrance. A long curvilinear gravel driveway penetrates hardwood and spruce woods in the ascent to the cleared and prominent house site. Electric power is already installed to that ideal plateau which includes selected mature trees and is laced with driveable trails. It is in close proximity to the lake, Golf Course and Island Green Restaurant. Moreover, Stonegate Hill Farm is handy to Hudson, Hillsdale, Copake, the Berkshires, skiing, the Taconic State Parkway and the train.

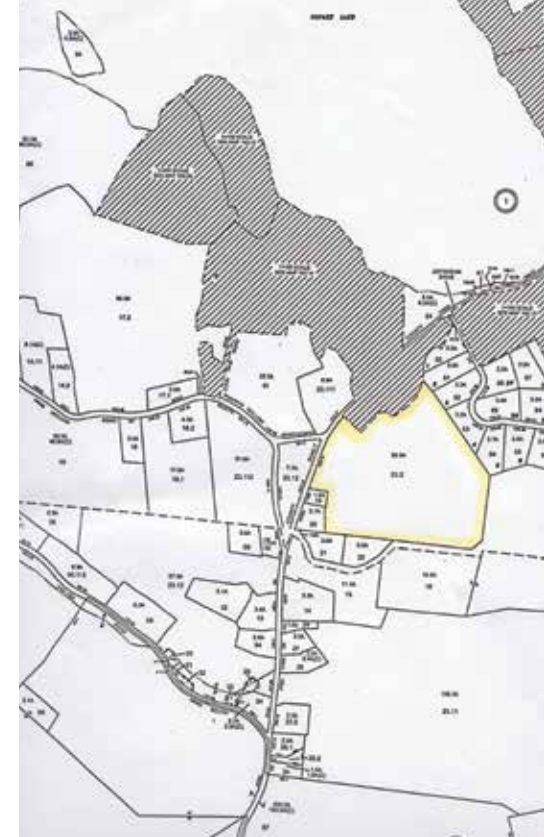

Property Features

- Lake View
- Catskill View
- Stone Pillars
- Privacy
- Driveway in Place
- Electric Power

#1 for Selling & Renting Fine Country Properties!

KLEMM REAL ESTATE Inc
LITCHFIELD COUNTY'S PREMIER BROKERS

Lakeville/Salisbury 860.435.6789 > Litchfield 860.567.5060 > Roxbury 860.354.3263
Sharon 860.364.5993 > Washington Depot 860.868.7313 > Woodbury 203.263.4040

klemmrealestate.com

Property Data

County Route 7
Copake, NY

Acreage: 59±

Price: Upon Request

Listing Agent: Drew Hingson
860.435.6789 Ext. 5

All Data to be confirmed by Buyer.